

DESIGNED BY: LM/BL
 CHECKED BY: TM/JBP
 DRAFTED BY: TM/DF

XREFS

SCALE: AS SHOWN

LAYOUT: G1

DATE TIME: 10/8/2016 8:06 PM

DRAWING LOCATION: Z:\PROJECTS\DOT\PP\Jewel Lake Road\Civil\1.3d\Production Drawings\57310_G1_Detention Grading.dwg

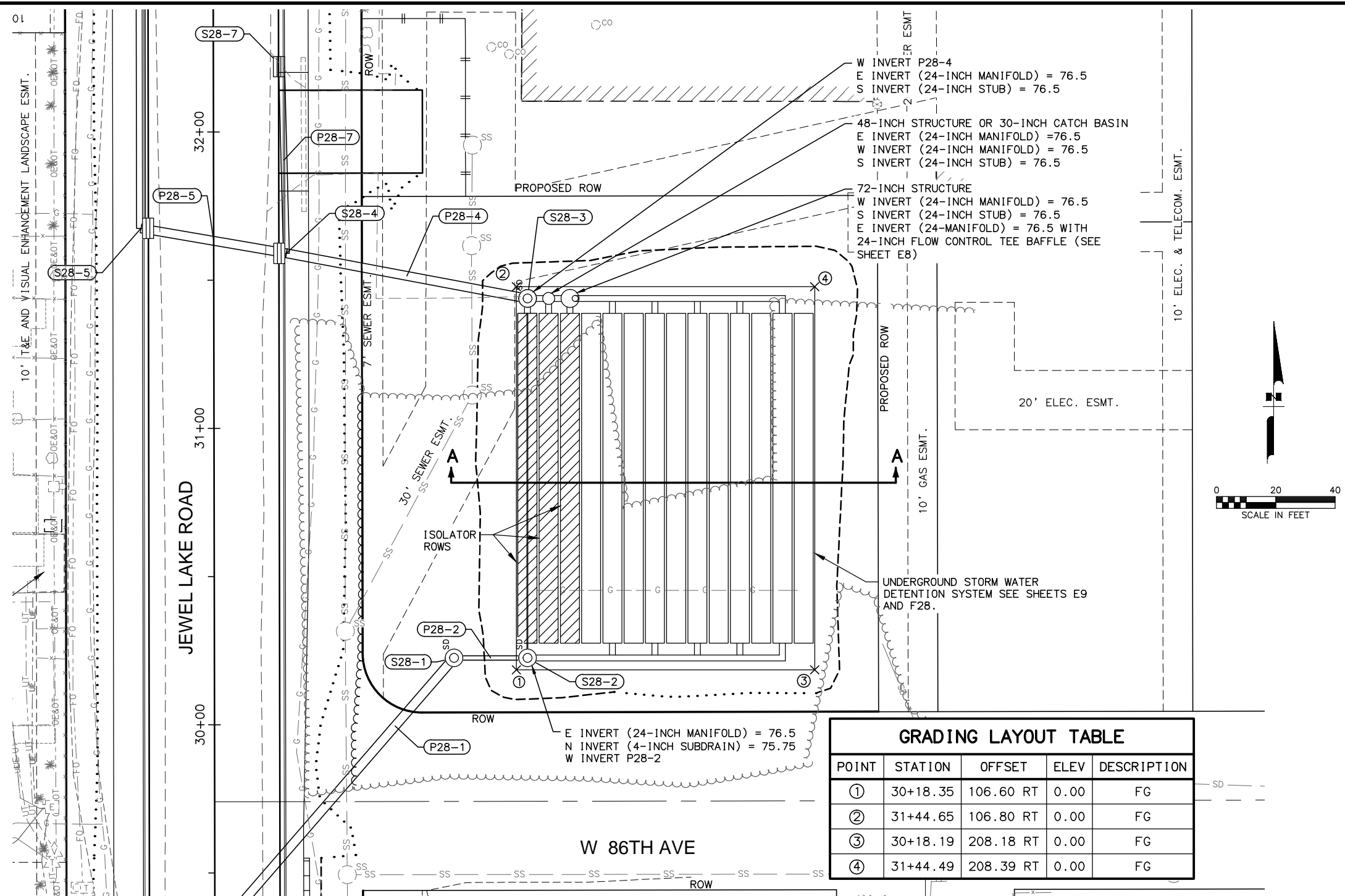

GRADING LAYOUT TABLE				
POINT	STATION	OFFSET	ELEV	DESCRIPTION
①	30+18.35	106.60 RT	0.00	FG
②	31+44.65	106.80 RT	0.00	FG
③	30+18.19	208.18 RT	0.00	FG
④	31+44.49	208.39 RT	0.00	FG

NOTE TO REVIEWERS:

GRADING PLAN PROVIDED IS FOR AN OPEN GRASS AREA ABOVE THE DETENTION BASIN. THIS MAY CHANGE DURING THE ROW PROCESS.

- NOTES:**
1. FINISHED GRADE ELEVATIONS ON TABLE ARE TO TOP OF TOPSOIL.
 2. PROVIDE 4" TOPSOIL AND SEED DISTURBED AREAS AND AS DIRECTED BY THE ENGINEER.

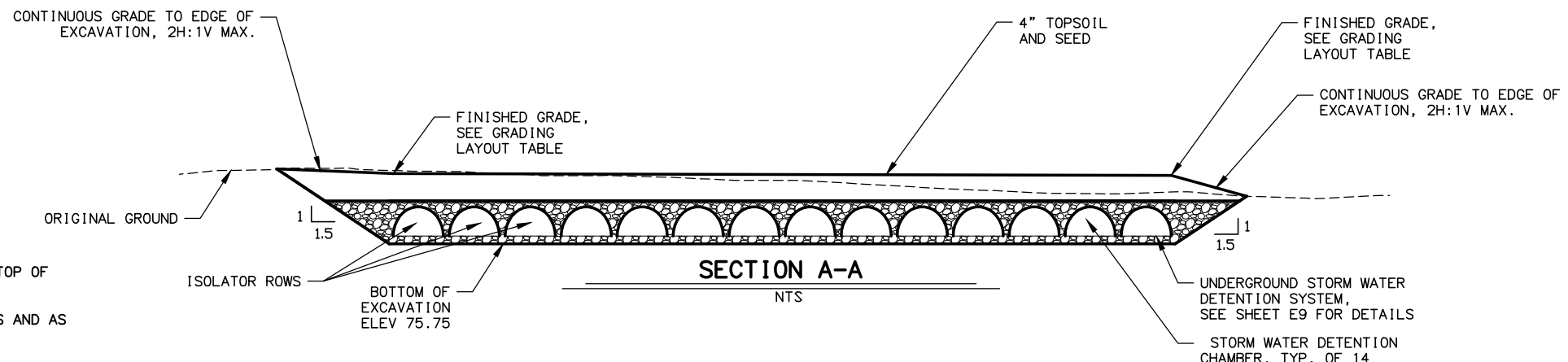

SHEET NO.	TOTAL SHEETS	
G1	G1	
STATE	YEAR	
ALASKA	2017	
PROJECT DESIGNATION		
0515005/Z573100000		
ADDENDUM NO.		
ATTACHMENT NO.		
REVISIONS		
NO.	DATE	DESCRIPTION
PLANS DEVELOPED BY: KINNEY ENGINEERING, LLC 3909 Arctic Blvd, Suite 400 Anchorage, Alaska 99503 (907) 346-2373 CERT. OF AUTH. NO. AECL 1102		
STATE OF ALASKA DEPARTMENT OF TRANSPORTATION AND PUBLIC FACILITIES HSIP: JEWEL LAKE ROAD WIDENING, 88TH AVE TO STRAWBERRY RD UNDERGROUND DETENTION SYSTEM GRADING PLAN		